

High-Reliability Air Core Inductors MS536RAT

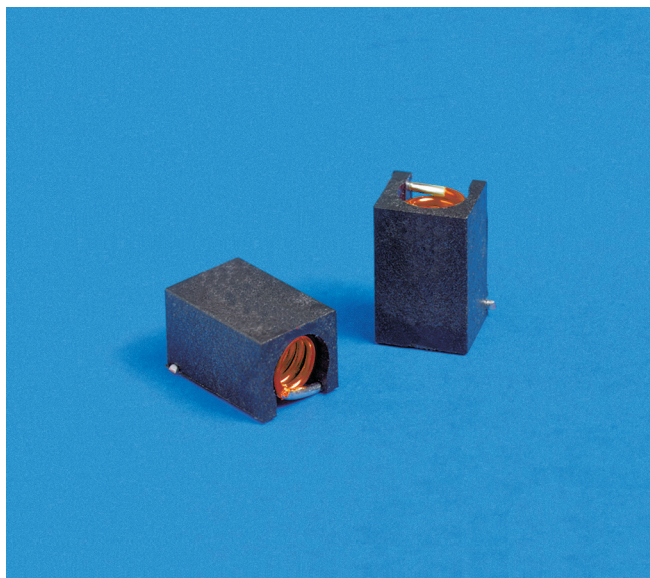

- High Q over a wide range of frequencies
- High temperature materials allow operation in ambient temperatures up to 155°C.
- Tin-lead (63/37) terminations ensure the best possible board adhesion

Terminations Tin-lead (63/37) over copper

Ambient temperature -55°C to +125°C with I_{max} current

Maximum part temperature +155°C (ambient + temp rise).

Storage temperature Component: -55°C to +155°C.

Tape and reel packaging: -55°C to +80°C

Resistance to soldering heat Max three 40 second reflows at +260°C, parts cooled to room temperature between cycles

Temperature Coefficient of Inductance (TCL) +5 to +70 ppm/°C

Moisture Sensitivity Level (MSL) 1 (unlimited floor life at <30°C / 85% relative humidity)

Enhanced crush-resistant packaging 800 per 13" reel
Plastic tape: 24 mm wide, 0.3 mm thick, 12 mm pocket spacing, 6.1 mm pocket depth

Part number ¹	Turns	Inductance ² (nH)	Percent tolerance	Q ³ min	SRF min ⁴ (GHz)	DCR max ⁵ (mOhm)	I _{max} (A)
MS536RAT90N_SZ	9	90	5,2	95	1.140	15	3.5
MS536RATR11_SZ	10	111	5,2	87	1.020	15	3.5
MS536RATR13_SZ	11	130	5,2	87	0.900	20	3.0
MS536RATR17_SZ	12	169	5,2	95	0.875	25	3.0
MS536RATR21_SZ	13	206	5,2	95	0.800	30	3.0
MS536RATR22_SZ	14	222	5,2	92	0.730	35	3.0
MS536RATR25_SZ	15	246	5,2	95	0.685	35	3.0
MS536RATR31_SZ	16	307	5,2	95	0.660	35	3.0
MS536RATR38_SZ	17	380	5,2	95	0.590	50	2.5
MS536RATR42_SZ	18	422	5,2	95	0.540	60	2.5
MS536RATR49_SZ	19	491	5,2	95	0.535	65	2.0
MS536RATR54_SZ	20	538	5,2	87	0.490	90	2.0

1. When ordering, specify **tolerance** code:

MS536RATR54GSZ

Tolerance: G = 2% J = 5%

- Inductance measured at 50 MHz on an Agilent/HP 4286A or equivalent with a Coilcraft SMD-A test fixture and correlation.
- Q measured at 50 MHz on an Agilent/HP 4291A or equivalent with a 16193A test fixture or equivalent.
- SRF measured on an Agilent/HP 8753ES or equivalent with a Coilcraft CCF1268 test fixture.
- DCR measured on a Keithley 580 Micro-Ohmmeter or equivalent.
- Electrical specifications at 25°C.

Refer to Doc 362 "Soldering Surface Mount Components" before soldering.

MS536RAT Series Air Core Inductors

S-Parameter files
ON OUR WEB SITE
SPICE models
ON OUR WEB SITE

Typical L vs Frequency

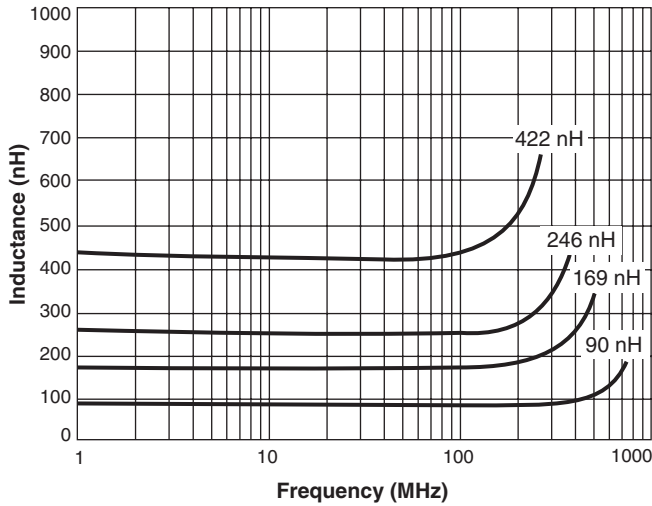

Typical Q vs Frequency

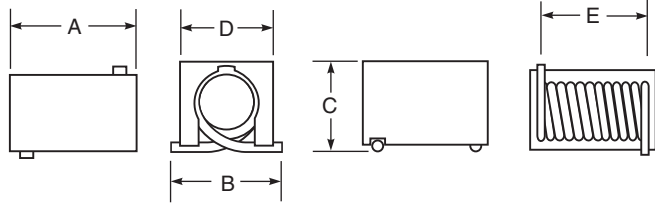
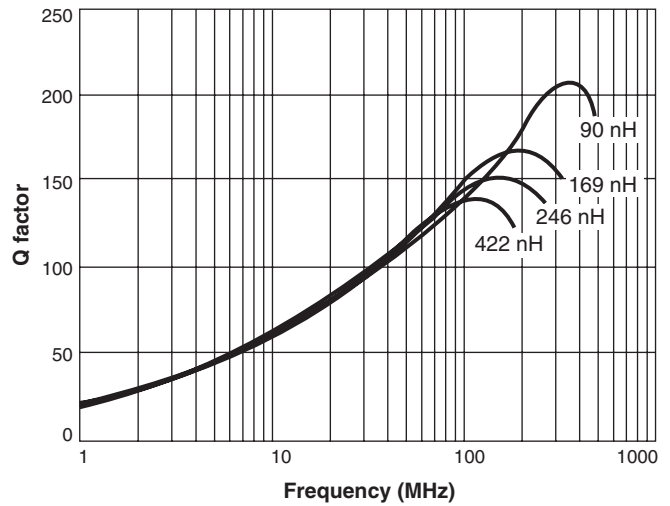

A max	B max	C max	D	E	
0.415	0.260	0.235	0.240 ±0.015	0.314 ±0.020	inches
10,55	6,60	5,97	6,10 ±0,38	7,98 ±0,51	mm

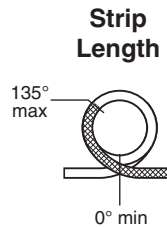

Suggested Land Pattern

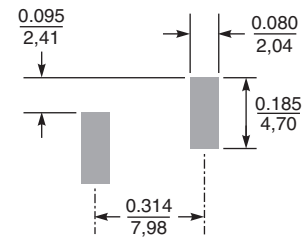

Dimensions are in $\frac{\text{inches}}{\text{mm}}$



CRITICAL PRODUCTS & SERVICES

1102 Silver Lake Road
Cary, IL 60013
Phone 800-981-0363

Fax 847-639-1508
Email cps@coilcraft.com
www.coilcraft-cps.com

Document MS185-1 Revised 06/21/22

This product may not be used in medical or high risk applications without prior Coilcraft approval. Specifications subject to change without notice. Please check our web site for latest information.